

Top Assembled View

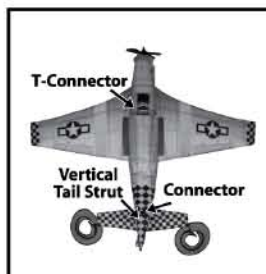

Bottom Assembled View

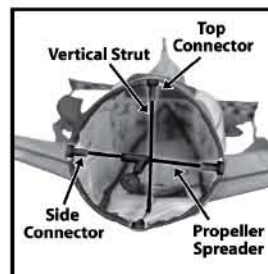

Front Assembled View

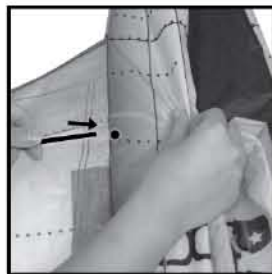

1. Insert Main Wing Spreader through the Hole.

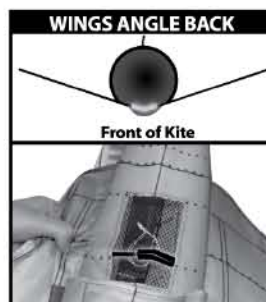

2. Insert Main Wing Spreader into T-Connector.

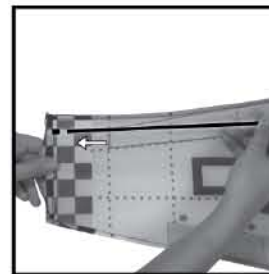

3. Insert Main Wing Spreader into Connectors. (Repeat Steps 1 & 2 for other side).

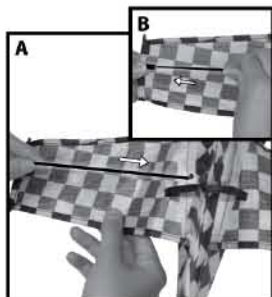

4. Insert Tail Wing Spreader through the Hole, slide all the way through & insert into Connectors (left/right).



5. Locate Vertical Tail Strut & insert end into Connector at the bottom.

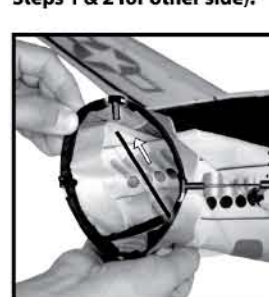

6. At front, insert Vertical Strut into Top Connector.

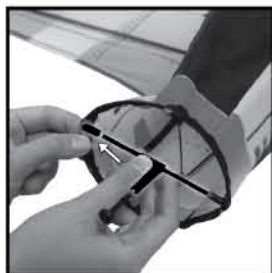

7. Insert Propeller Spreader into Side Connector.



8. Remove Ring & put Propeller on. Put Ring back to secure Propeller.

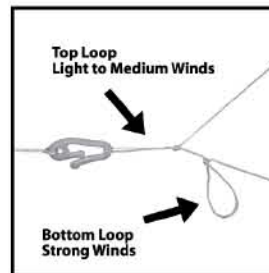

Attach the QuikClip® to the Bridle Loop. Top Loop for Light to Medium Winds, Bottom Loop for Strong Wind. For Strong Wind conditions, tie SkyStreamers™ to the Loops (left/right).

## LAUNCHING - ASSISTED LAUNCH

- The kite requires a minimum wind of 7 mph/11.3 kph. Let out approximately 75 feet/22.9 m of line and have an assistant hold the kite.
- With your back to the wind, release the kite and take a few steps backwards, the kite will rise into the air. Tug line to gain altitude, let out line to gain distance.
- For storage, reverse assembly steps and place into tube. Store your kite in a cool dry place. Excessive heat and/or sunlight can damage the package and kite.

## KITE SAFETY

**WARNING!** Do not fly near overhead power lines.  
**WARNING!** Do not use near overhead power lines or during thunderstorms.  
**WARNING!** Not suitable for children under 3 years due to small parts.  
**WARNING!** Not suitable for children under 3 years due to long cord.  
 Please remove all packaging material before giving the toy to child.  
 Keep important information for future reference.

Never fly near an airport.  
 Never fly over people.  
 Never fly in thunderstorms.  
 Never fly near busy streets.  
 Never fly near overhead power lines.  
 Never try to retrieve your kite from power lines.  
 Call your local power company for assistance.